

Visit Date: \_\_\_\_\_

Teacher: \_\_\_\_\_

**School Visit Schedule**

Time	Activity (program, self-guided exploration, lunch, etc.)	Notes

**School Programs: Chaperone Responsibilities**

- ✓ **Know** your visit schedule. For scheduled programs, groups meet/check-in at Visitor Services 10 minutes before the start time to be escorted to the program area (4<sup>th</sup> floor, ? on map).
- ✓ **Respect** the 1:5 adult to student ratio in the classroom (parents & teachers) and 25 person maximum for gallery programs. Programs are limited to students and chaperones; no siblings.
- ✓ **Help** support a fun and effective learning environment by modeling good behavior during programs (e.g. do not use cell phones or talk) and assisting with activities when appropriate.
- ✓ **Stay** with your group of students while exploring the museum and actively monitor and manage their behavior. Note: consumption of food and drink in the museum is prohibited.

**Car Parking:** Mississippi Street Garage (<http://parking.ku.edu/parking-garages>).

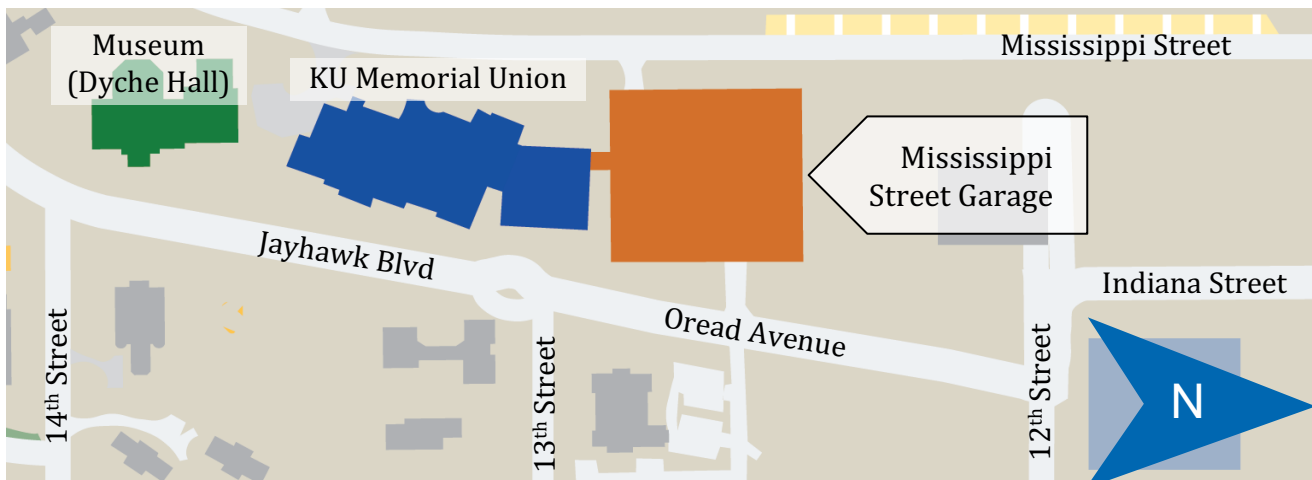

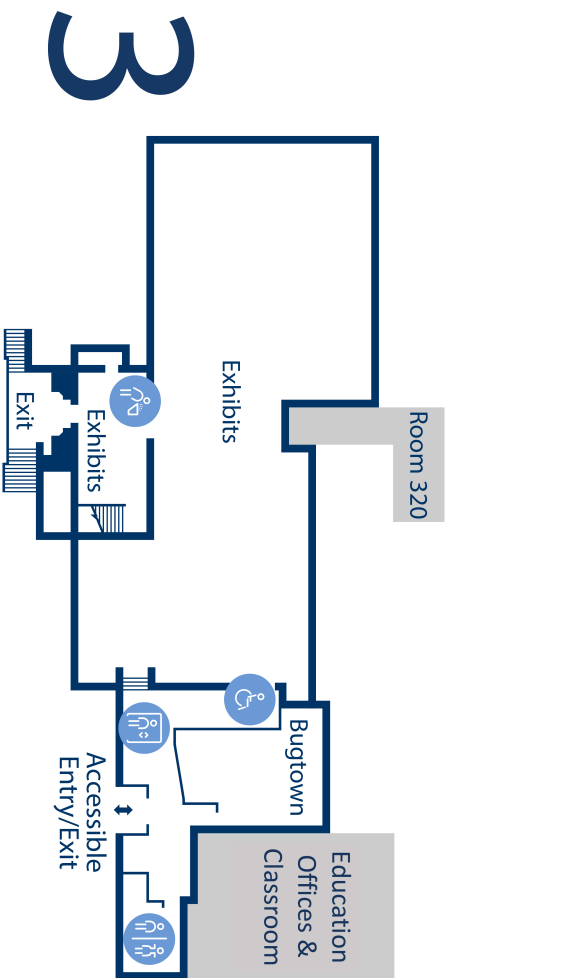

Water Fountain | Elevator | Restrooms

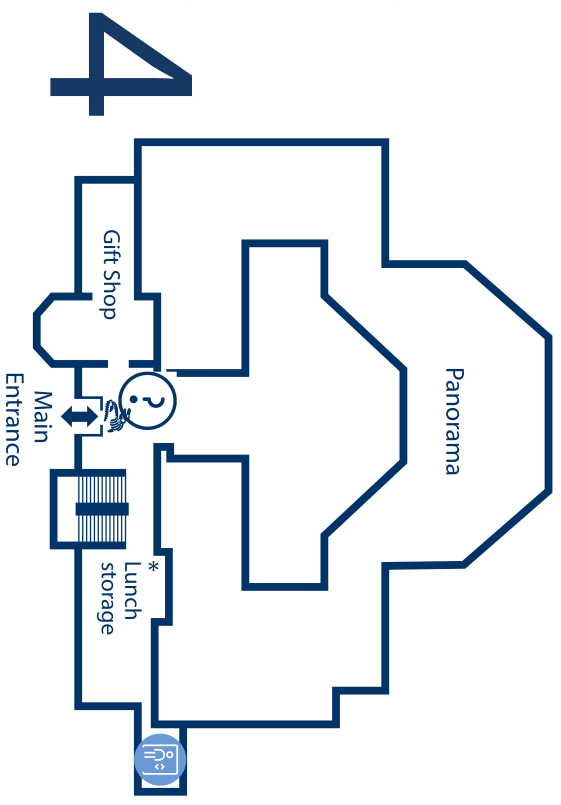

Visitor Services | Lunch storage | Elevator

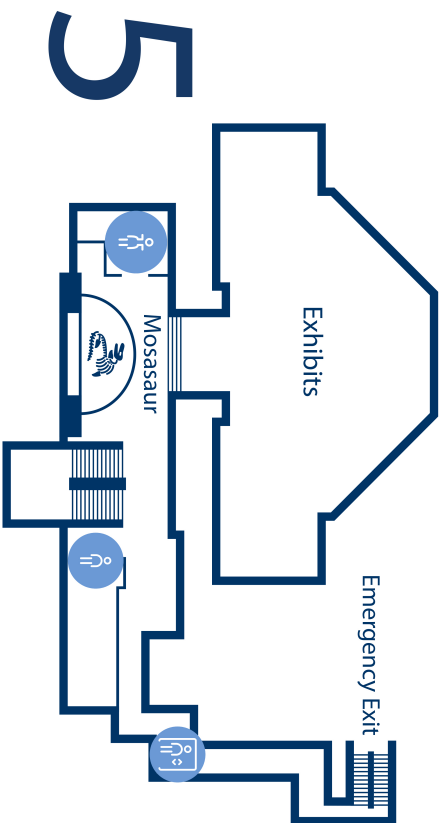

Restrooms | Elevator

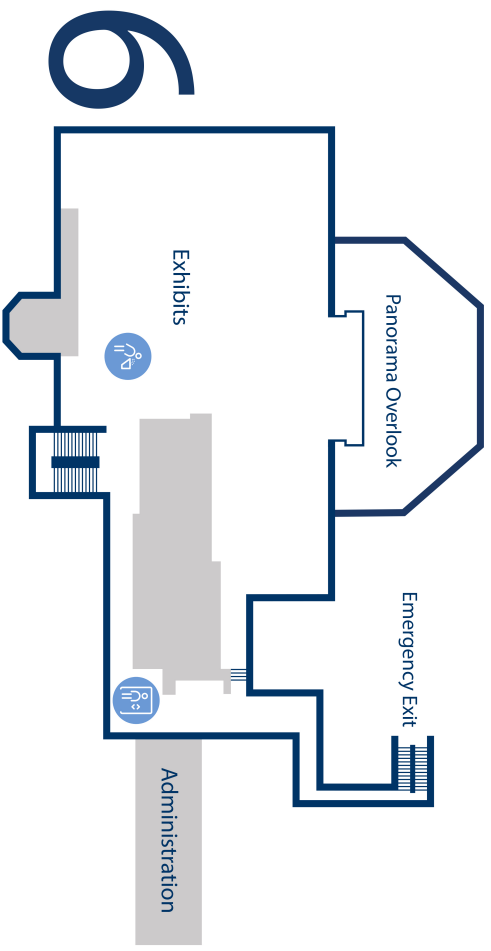

Water Fountain | Elevator